

# Diaphragm seals threaded types

## Model DS21

Threaded connections to ANSI/ASME or ISO

### Features

- Removable diaphragm seal capsule
- Interchangeable components
- Removable top and bottom housing
- Variety of wetted parts materials

### Ranges

15 psi up to 1,500 psi  
1 kg/cm<sup>2</sup> up to 100 kg/cm<sup>2</sup>

### Applications

Chemical and petrochemical industry  
Machine and apparatus construction  
Offshore installations  
Pulp and paper industry  
Waste water treatment

Technical specification	DS21
Process connection size	1/4" 3/8" 1/2" BSP / NPT (M), M20x1.5(M)
Construction	Bolted top and bottom housing, removable for easy maintenance and changeable capsules
Fill port	At the side with stainless steel ball and set screw
Flushing connection	Optional flushing
Flushing connection size	1/4" 1/2" NPT female
Maximum pressure	
Standard [kg/cm <sup>2</sup> ]	70
With high pressure ring [kg/cm <sup>2</sup> ]	100
Measuring principle	Screwed capsule
Instrument connections [female]	3/8" BSP, 1/2" NPT, others on request
Material (wetted parts)	
Bottom housing	Stainless steel 316, Polypropylene, PVC, Monel, Hastelloy C, SS 316 with teflon protection,
Diaphragm (metal type)	Stainless steel 316L (1.4404), stainless steel 304L (1.4306), K-Monel, Hastelloy C, Hastelloy B, Nickel, Carpenter 20, Tantalum
Material (non wetted parts)	
Top housing	Stainless steel 304, optional 316
Clamps, rings	Steel painted black, optional stainless
Bolts and nuts	Stainless steel 300 series
Accuracy	Additional 0,5 % to the specified tolerance of the mounted instrument
Filling liquids (temperature range)	Glycerin (0/400 °F, -18/204 °C), silicone (-40/600 °F, -40/315 °C), halocarbon (-70/300 °F, -56/149 °C), Syltherm 800 (-40/750 °F, -40/400 °C), vegetable oil (32/248 °F, 0/120 °C) Others on request, also depending on selected material and configuration.
Mounting	Direct or with capillary
Weight dry in kg	
Accessories, options	NACE, pressure gauges, pressure switches, transducer, capillaries

## General dimensions in mm

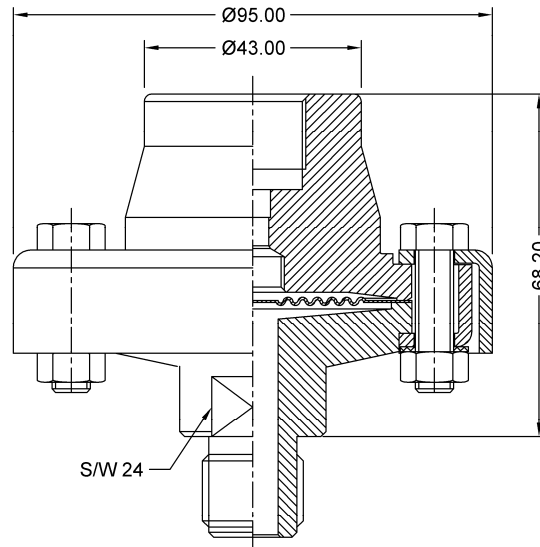

## Order information

Process connection	Type	Diaphragm	Bottom housing material	Instrument connection	Filling fluid	Options
(06) 1" NPT(M)	DS21	(S) 316L	(S) 316	(14T) 3/8 BSP (F)	(CG) Glycerin (direct mounted, -18/204 °C)	(NH) Tagging wired
(05) 3/4" NPT(M)		(C) 304L	(L) 316L	(04T) 1/2" NPT (F)	(CK) Silicone (direct mounted or with capillary, -40/315 °C)	(OF) Oil free (only filled with halocarbon)
(04) 1/2" NPT(M)		(D) Carpenter 20	(SP) 316 with teflon lined <sup>1)3)</sup>		(CF) Halocarbon (direct mounted or with capillary, -56/149 °C)	(YT) Stainless steel 316 top housing
(03) 3/8" NPT(M)		(G) Hastelloy B	(PP) Polypropylene <sup>2)</sup>		(HA) Syltherm 800 (direct mounted or with capillary, -40/400 °C)	(SE) Stainless steel clamp rings
(02) 1/4" NPT(M)		(H) Hastelloy C	(V) PVC <sup>2)</sup>		(GZ) Vegetable oil (direct mounted or with capillary, 0/120 °C)	(PU) Flushing connection 1/4" NPT (F)
(18) 1" BSP(M)		(N) Nickel	(H) Hastelloy C			(CA) Stainless steel ar- mored capillary <sup>4)</sup>
(17) 3/4" BSP(M)		(P) K-Monel	(M) Monel 400			(CP) Stainless steel ar- mored capillary with PVC sleeving <sup>4)</sup>
(15) 1/2" BSP(M)		(U) Tantalum				
(14) 3/8" BSP(M)						
(13) 1/4" BSP(M)						
(16) M20x1.5(M)						
(06T) 1 NPT(F)						
(05T) 3/4 NPT(F)						
(04T) 1/2" NPT(F)						
(02T) 1/4" NPT(F)						

others on request

1) Restricted to temperature 65 °C, pressure 40 bar

2) Max. Rating / temperature limit: 200 psi/14 bar at 74 °F/23 °C; 125 psi/8.6 bar at 125 °F/52 °C; 80 psi/5.5 bar at 150 °F/65 °C

3) Not for process connection (02), (13), (06T), (05T), (04T), (02T)

## How to order

Process connection	Type	Diaphragm	Bottom housing material	Instrument connection	Filling fluid	Option
04	DS21	S	S	14T	CK	CA1000

## Ashcroft India Pvt. Ltd.

Plot No.: 2306, G.I.D.C. Chhatral, Ta: Kalol, Dist.: Gandhinagar,  
 CHHATRAL 382 729, Gujarat, INDIA.  
 Telephone: +91 (0) 2764 233681/82/83 Fax: +91-2764-233440  
 Email: sales@ashcroftindia.com www.ashcroftindia.com

- North Zone : sales.delhi@ashcroftindia.com
- East zone : sales.kolkata@ashcroftindia.com
- West zone : sales.mumbai@ashcroftindia.com
- South zone : sales.chennai@ashcroftindia.com